

AVAILABLE > 34,000 SF (EXPANDABLE TO 52,750 SF)



1351 Enterprise Drive

ROMEOVILLE, IL

CRANE FACILITY

RENOVATIONS UNDERWAY

LED Lighting
New Exterior Painting
Refinished Warehouse Flooring and Painted Panels
Landscaping Upgrades



About This Property

- > **Rare, stand-alone crane facility in the heart of I-55 Corridor**
- > Size: 34,000 SF (expandable to 52,750 SF)
- > Office: 4,000 SF
- > Site: 2.31 Acres
- > Cranes: 8 Demag, RF controlled cranes (3T, 5T and 10T)
- > Ceiling Height: 22'; 16' under hook
- > Columns: 50' wide bays
- > Zoning: M-1
- > Parking: 31 Car (expandable)
- > Loading: 3 Drive in doors (drive through capability)
- > Power: 800 Amp/480 V
- > Floors: 8" Thick
- > Lease Rate: STO
- > Year Built: 1996
- > **Built and owned by Northern Builders, Inc.**

Contact Us

DAVID BERCU
847 698 8207
david.bercu@colliers.com

JOHN BASILE
847 698 8259
john.basile@colliers.com



No warranty or representation is made to the accuracy of the foregoing information.
Terms of sale or lease and availability are subject to change or withdrawal without notice.

COLLIERS INTERNATIONAL
6250 N. River Road, Suite 11-100
Rosemont, IL 60018
www.colliers.com

1351 Enterprise Drive > Floor Plan

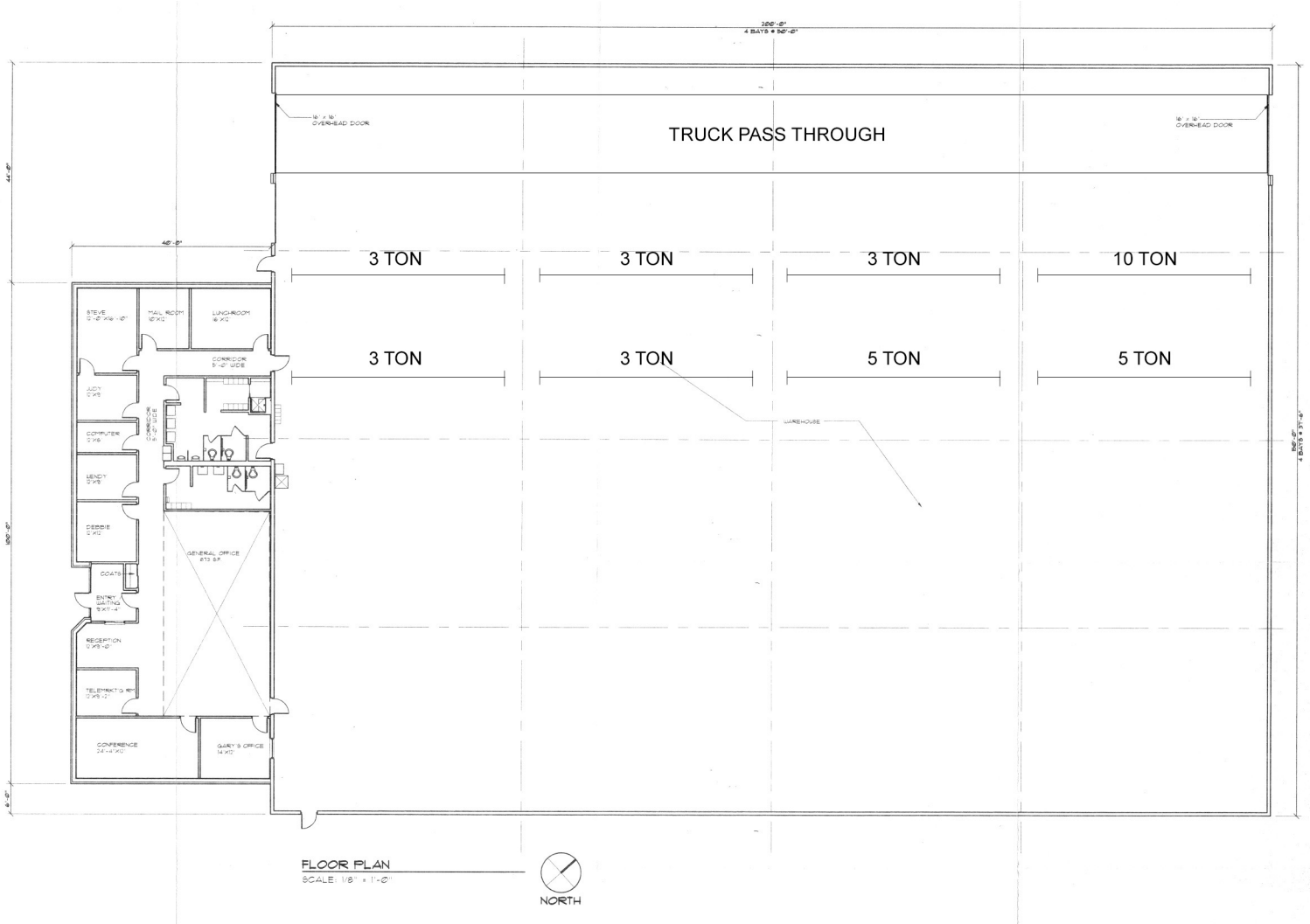

1351 Enterprise Drive > Site Plan

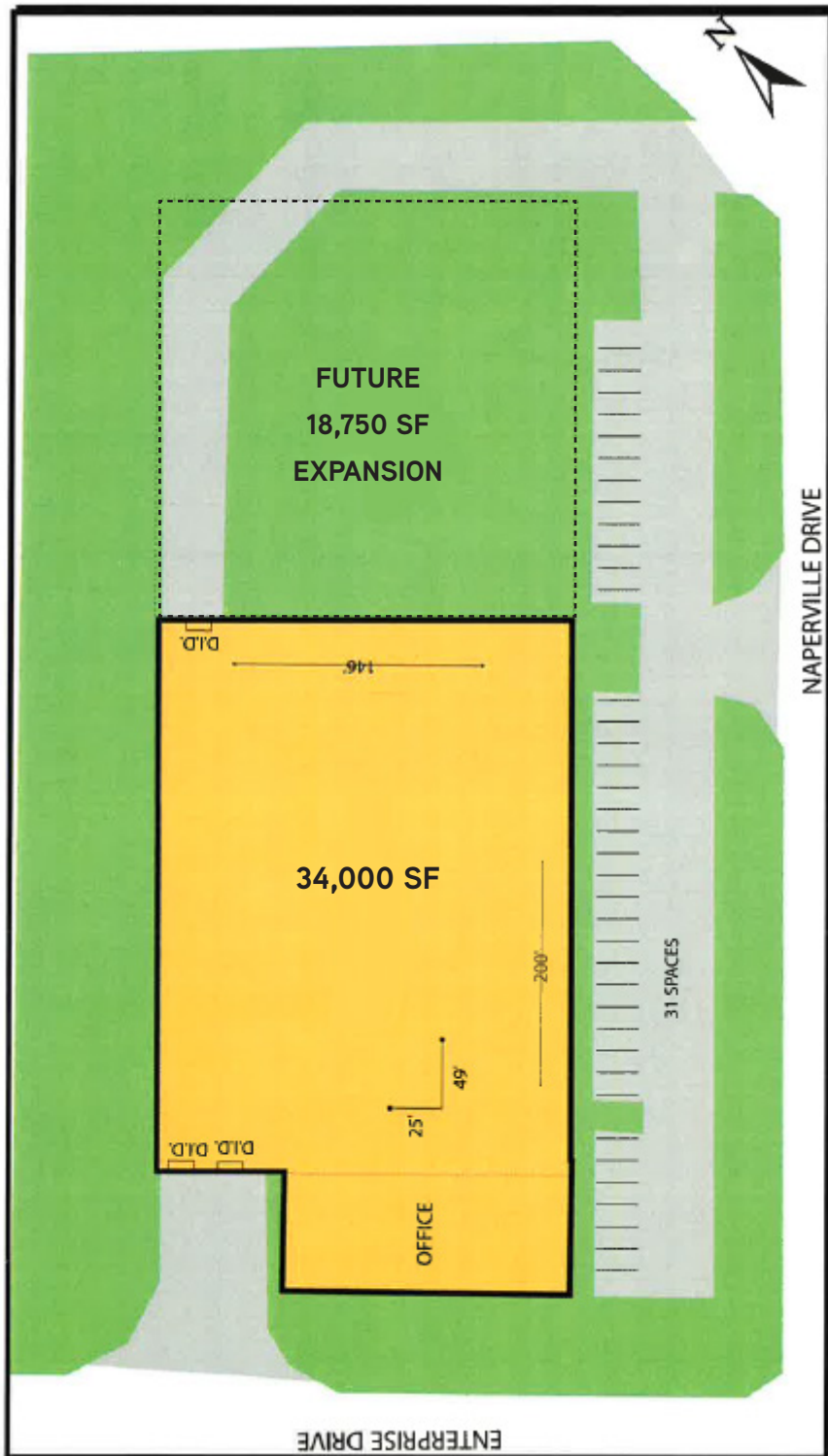

DAVID BERCU
847 698 8207
david.bercu@colliers.com

JOHN BASILE
847 698 8259
john.basile@colliers.com

